



# DATA SHEET

## DC Leakage Current Sensor

P/N: CHD\_CRS12S485

$I_{PN}=10\sim 20\text{mA}$

### Feature

- DC Leakage Current Sensor develops on base of magnetic modulation closed loop principle
- Apply unique patented technology for measure tiny current (mA level)
- Supply voltage: DC +12 V

### Advantages

- High accuracy
- Easy installation
- Wide current measuring range
- Optimized response time
- Low power consumption
- High immunity to external interference
- Very good linearity
- Can be customized

### Applications

- The current detection of the lift
- DC panel detection
- The signal system
- Current differential detection
- AC variable-speed drive/ Servo drive
- UPS and Inverter applications



RoHS



### Electrical data:

Parameter Ref	CHD10CRS12S485	CHD20CRS12S485
Rated input $I_{pn}$ (mA)	$\pm 10$	$\pm 20$
Measuring range $I_p$ (mA)	$0\sim\pm 15$	$0\sim\pm 25$
Means of communication(V)	RS485	
Supply Voltage $V_{DC}$ (V)	DC +12V ( $\pm 5\%$ )	
Current consumption $I_c$ (mA)	<30	
Galvanic isolation $V_d$	2.5KV /50Hz/1min	
Accuracy X(%)	TA =25℃	$\pm 1$
Linearity $\varepsilon_L$ (%FS)	<1	
Offset Current drift $I_{OT}$ (mA)	$\leq 0.01$	
Bps (bps)	9600	
Load resistance $R_L$ ( $\Omega$ )	$\geq 10K$	



Cheemi Technology Co., Ltd

Tel: 025-85996365

E-mail: [info@cheemi-tech.com](mailto:info@cheemi-tech.com)

[www.cheemi-tech.com](http://www.cheemi-tech.com)

Add:N22, Xianlongwan, Xianyin South Road, Qixia District, Nanjing - China.

## General data:

Parameter	Value
Operating temperature TA(°C)	-10 ~ +65
Storage temperature TS(°C)	-25~ +70
Plastic material	PBT G30/G15, UL94- V0;
Standards	IEC60950-1:2001
	EN50178:1998
	SJ20790-2000

## Dimensions(mm):

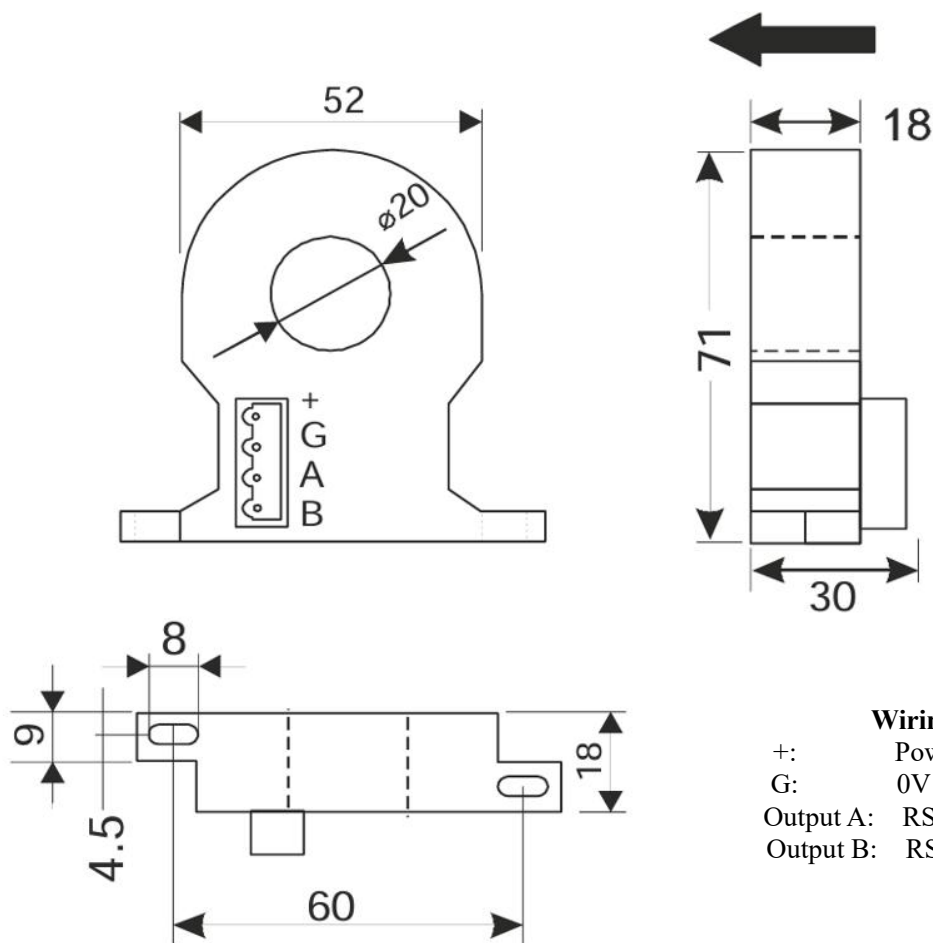

### Wiring

+: Power supply voltage +12V  
 G: 0V  
 Output A: RS485+  
 Output B: RS485-

## Remarks:

- The wrong wiring may lead to damage of sensors, after the power supply when the electric current to be measured through the sensor direction arrow, can be measured at the output end in phase voltage value.
- When the current goes through the primary pin of a sensor, the voltage will be measured at the output end.
- Custom design is available for the different rated input current and the output voltage.
- The output of the sensor amplitude can be adjusted as appropriate to the user requirement
- The dynamic performance is the best when the primary hole if fully filled with.
- The primary conductor should be <100°C.

**WARNING : Incorrect wiring may cause damage to the sensor.**



Cheemi Technology Co., Ltd

Tel: 025-85996365

E-mail: [info@cheemi-tech.com](mailto:info@cheemi-tech.com)

[www.cheemi-tech.com](http://www.cheemi-tech.com)

Add: N22, Xianlongwan, Xianyin South Road, Qixia District, Nanjing - China.